



## SONAY SHIPPING

Dünyayı taşıyoruz...

- ANASAYFA
- Sonay Shipping Gemiler
- FİRMA PROFİLİ
- GEMİLER



# M/V SABAHAT SONAY



M/V SABAHAT SONAY	
<b>OWNER</b>	<b>AY DENİZCİLİK A.Ş. / AY SHIPPING A/S (FOR M/V SABAHAT SONAY)</b>
<b>MANAGER</b>	<b>SONAY DENİZCİLİK / SONAY SHIPPING</b>
ADRESS	Hacıoğulları Plaza Ankara Asfaltı Tuzla Yolu Üzeri 37490 TUZLA-İSTANBUL/TURKEY
PHONES	+90 216 446 23 06 (PBX) / +90 216 446 71 00 (PBX) / +90 216 446 68 78
FAX	+90 216 446 25 70 / +90 216 446 25 67
TELEX	36036 HNS.TR / 36037 HCI.TR
EMAIL	<a href="mailto:sonay@tnn.net">sonay@tnn.net</a> / <a href="mailto:sonay@sonayshipping.com">sonay@sonayshipping.com</a> / <a href="mailto:sonayshipping@superonline.com">sonayshipping@superonline.com</a> / <a href="mailto:info@haciogullari.com.tr">info@haciogullari.com.tr</a>
WEB	<a href="http://www.sonayshipping.com">www.sonayshipping.com</a> - <a href="http://www.haciogullari.com.tr">www.haciogullari.com.tr</a>
<b>CLASSIFICATION</b>	<b>BV I X HULL X MACHINERY , GENERAL CARGO SHIP, UNRESTRICTED NAVIGATION, X AUT-UMS, CLEAN SEA, MONSHAFT, INWATER SURVEY, SYS NEQ-1</b>
<b>CERTIFICATED WICH WILL BE ISSUED BY BV ONBEHALF OF ADMINISTIRATOR</b>	<b>IOPP Certificates (Annex I, Annex V &amp; Annex IV), Approval of Grain Loading, ILLC, Approval of Damage Stability, Cargo Securing Manual, Document of Compliance for the Carriage of Dangerous Goods Appendix A-B-C, Crew Accommodation ( ILO 92-133 ), ILO 152 Cargo Gear, Document of Compliance U.S Coast Guard 33 CFR Part 155 "Oil Pollution Prevention", Panama &amp; Suez canal Tonnage, Attestation of Compliance for Suez Canal Navigation Rules, Attestation of</b>

**Compliance for Panama Canal Navigation Rules, Attestation of Compliance for St. Lawrence Seaway Navigational Rules, SMS/SMC, ISPS/ISSC**

**OTHER NOTATIONS** HEAVY CARGO, TIMBER, CONTAINER ON HATCH COVERS abt. 304 TEU

**MAIN PARTICULARS OF SISTERSHIPS**

SHIP TYPE	MULTIPORPOUSE GENERAL CARGO
SHIPYARD	ÇELİK TEKNE SHIPYARD/TUZLA-İSTANBUL/TURKEY
BUILT YEAR / HULL NO	<b>2006 - NB066</b>
Acc. To delivery date abt.	30.12.2006
KEEL LAYING DATE	<b>30.12.2004</b>
IMO NO	<b>9370525</b>
LENGTH (L.O.A.)	143,41 Mtrs.
LENGTH (P.P.)	134,00 Mtrs.
LENGTH (L.W.L.)	137,13 Mtrs.
BREADTH (Moulded)	21,70 Mtrs.
DEPTH (Moulded)	11,10 Mtrs.
DRAFT (Design)	8,243 Mtrs.
DRAFT (Scantling)	8,30 Mtrs.
DISPLACEMENT (Scantling)	17920 T
DEAD WEIGTH About	13250 M/T
GROSS TONNAGE	9640 M/T
NET TONNAGE	4677 M/T
T.C.P.	25 T
AIR DRAFT	31,5 mtrs
F.O. TANK VOLUME	728 m <sup>3</sup>
D.O. TANK VOLUME	268 m <sup>3</sup>
FRESH WATER	143 m <sup>3</sup>
BALLAST TANK CAPACITY	5386 m <sup>3</sup>
CARGO VOLUME	16910 m <sup>3</sup> including Hatch Coamings
HOLDS	4 Holds Doble Skin & "Box Shape" Type
NO 1 HOLD	Box Shape 12,60mx12,06m - 1655,62m <sup>3</sup> - Inner Bottom with max. Area of 40 m <sup>2</sup> 196 kN/m <sup>2</sup>
NO 2 HOLD	Box Shape 25,60mx17,20m - 5310,78m <sup>3</sup> -Inner Bottom with max. Area of 225 m <sup>2</sup> 196 kN/m <sup>2</sup>
NO 3 HOLD	Box Shape 25,60mx17,20m - 5352,36m <sup>3</sup> -Inner Bottom with max. Area of 225 m <sup>2</sup> 196 kN/m <sup>2</sup>
NO 4 HOLD	Box Shape 19,20mx17,20m - 4060,20m <sup>3</sup> -Inner Bottom with max. Area of 225 m <sup>2</sup> 196 kN/m <sup>2</sup>
HATCH COVER STRENGTH	1,75 T/m <sup>2</sup>
HATCH COVERS	Haydroulic Operated , Foulding Type
CONTAINER CAPACITY	304 TEU On Hatch Cover
MAIN ENGINE	MAN B&W 6S35MC Mk-7, 4440kW, 173 Rpm, Two Stroke Engine with Step-Up Gear for Shaft Gen.
PROPULSION SYSTEM	Controllable Pitch Propeller ALPHA VBS 980 & Alpatronic 2000
SHAFT GENERATOR	LERROY SOMMER, 600kW, 50Hz, 1500Rpm
FUEL OIL & CONSUPTION	Intermediate Fuel Oil 380 cSt
SPEED	14,5 Knots abt.
IFO Consumption/day	19 T/day abt.
MDO Consumption at sea	0,5 T/day abt.
MDO Consumption at port	0,7 T/day at idle position abt.
MDO Consumption at port	1,4 T/day with 3 Cranes operation abt.
CARGO CRANES	3 No of NMF PKL 330 Piston Type , 30 M/T, 22 Mtrs. Outreach
BOW THRUSTER	SCHOTTEL STT 330 T-LK, 450kW
DANGEROUS GOODS	<b>ALL HOLDS Equipped to Carry of Dangerous Goods acc. To SOLAS II-2 R.54 (Restricted)</b>
VENTILATION	Cargo Hold Fans Exproof, 6 Airchanges/hrs ACC. Dangerous Goods Regulations
NAVIGATION	INTEGRATED BRIDGE acc. To BV SYSNEQ-1 equipped by SAM Electronics
AUXILIARY & EMERGENCY	MAN LINDENBERG 3x330kW 1500rpm, 400V AC Auxiliary, 50Hz 6 1x105kW 1500rpm, 400V AC, 50Hz



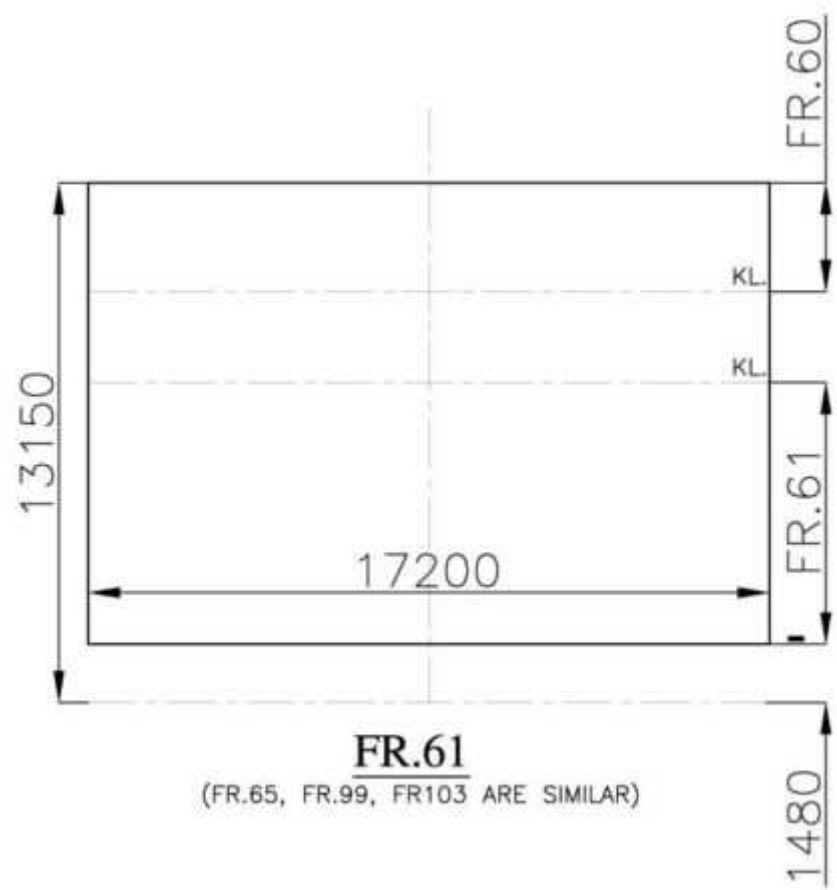
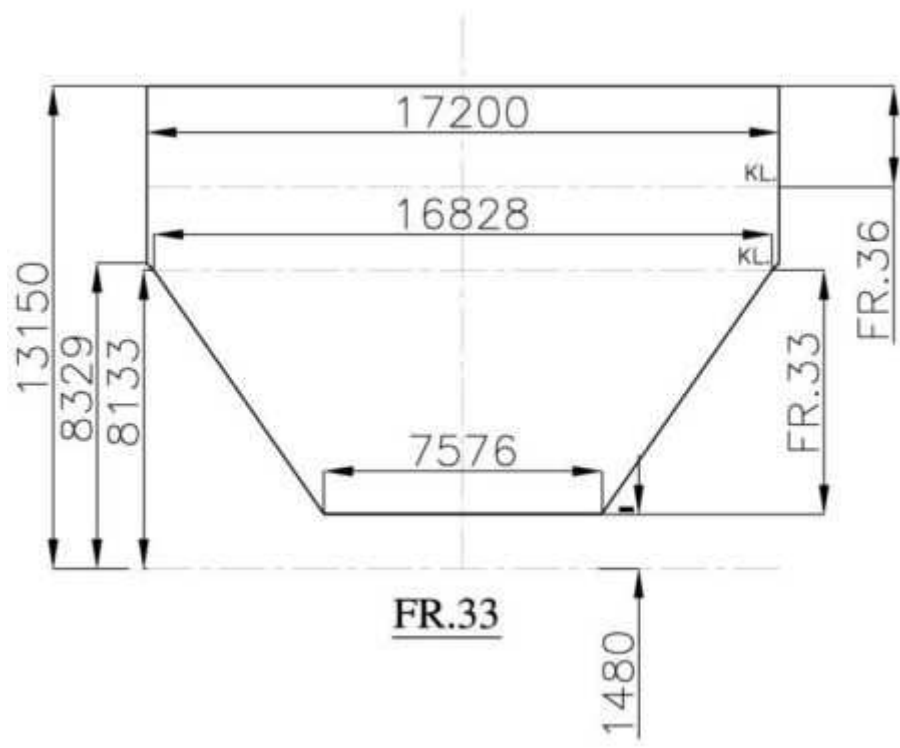

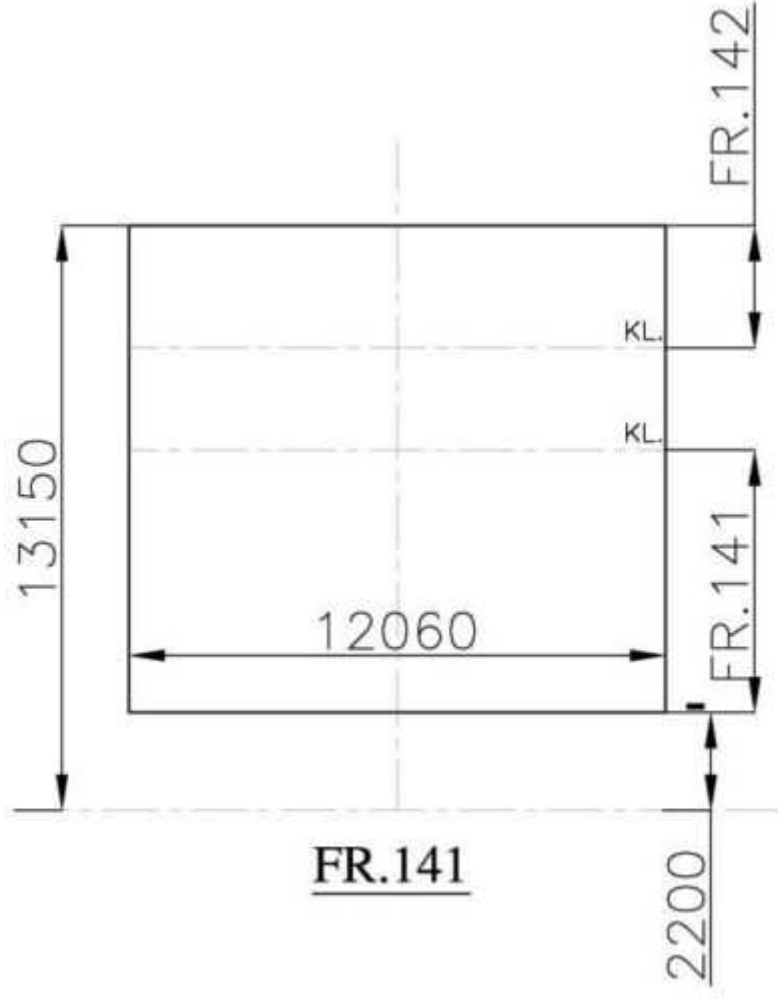
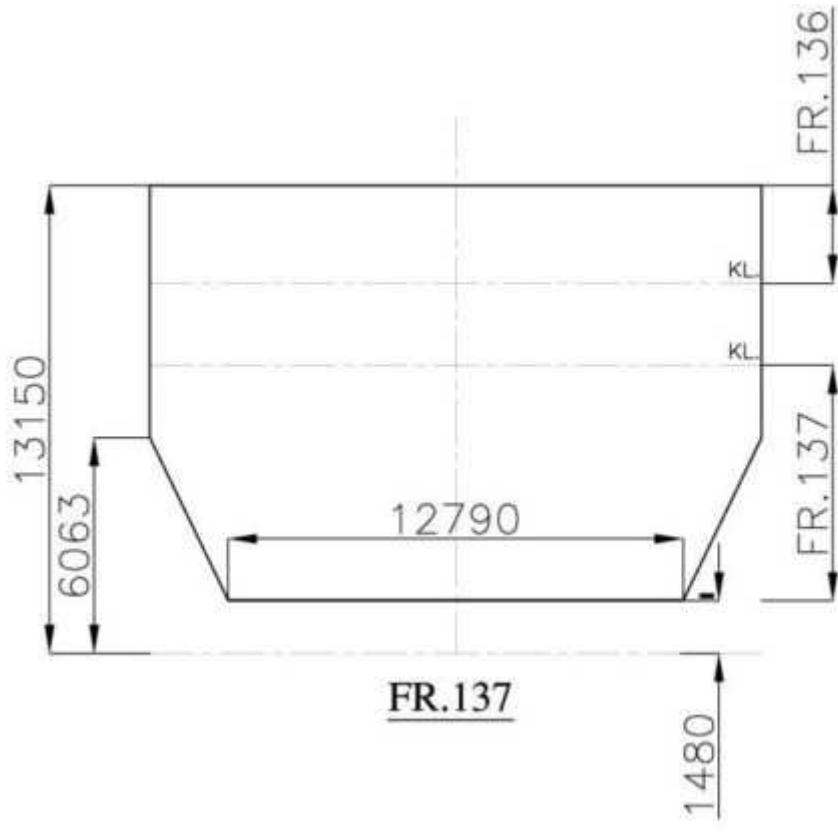

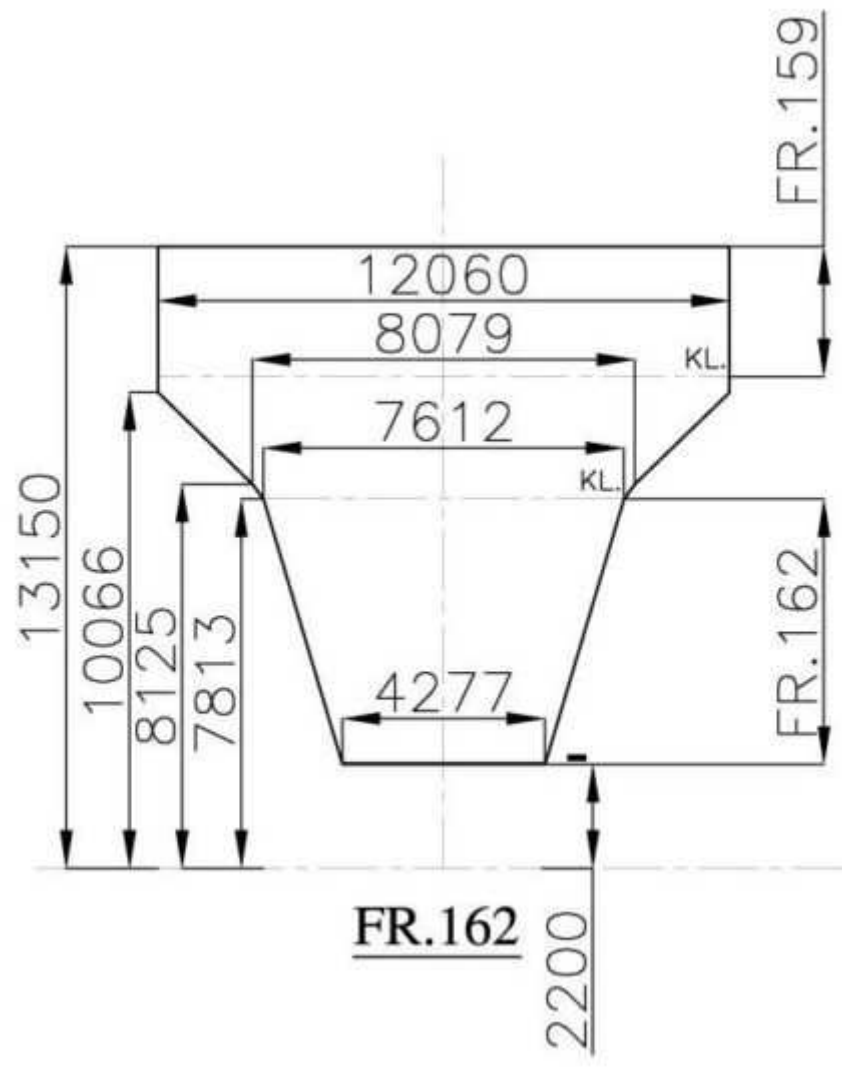

[Detaylı gemi çizimi için lütfen tıklayınız...](#)